

# SafetyWrap® Station

Portable Wrapping Station with Integrated Dating Label Dispenser



**SAN JAMAR**

Smart ♦ Safe ♦ Sanitary

# SafetyWrap® Station Instructions

Thank you for purchasing San Jamar's SafetyWrap® Station a Portable Wrapping Station with Integrated Dating Label Dispenser. We are confident your operation will enjoy food safety and efficiency benefits for years to come. Please take a moment to review the key features and instructions for use.

**Capacity:** Foil/Film: 12" width up to 18.5" length; 5.1" diameter  
Date Labels: 3.25" max. diameter; 2.25" max roll width

## CONTENTS



(1) SafetyWrap® Station



(4) Cutting Blades  
(1 installed)



(2) Roll Width  
Adaptors



(4) Rotation Label  
Roll Dividers



(1) Support Rod



(2) Wall Mounting  
Brackets

## Getting Started:

- Please clean and sanitize your SafetyWrap® Station before first use.
- Please read entire Instructions including *Cautions for Safety and Best Results* before first use.
- Please ensure all users of this product are properly trained on instructions for use; retain this instruction sheet for future reference and training.

## Versatile Options for Use

### • Countertop, Table Top or Wall Mount

*Note:* For maximum safety, ensure suction cups are securely engaged on the surface before use.

### • Hanging on Wire Shelving

The integrated hook feature in the back of the unit allows secure hanging and use on standard wire shelves. Simply hang the unit on the shelf ensuring hooks engage tightly with the shelf.



SafetyWrap® Station  
on wire shelving



SafetyWrap® Station mounted on wall  
using brackets

**Note:** Mounting fasteners are not included with the Wall Brackets. Make sure to select fasteners and wall anchors suitable for the wall type you will be mounting to, and are capable of supporting a weight of at least 20 lbs per bracket.

## Cleaning

- SafetyWrap® Station is dishwasher safe and should be cleaned before first use, then as needed to ensure sanitary use.
- Before washing, ensure all tools, dating labels and film/foil rolls are removed.
- Your unit has drain holes on the bottom to ensure complete draining of wash, rinse and sanitize water.
- Always ensure unit is completely dry before loading rolls and tools as well as general use.

# Instructions For Use

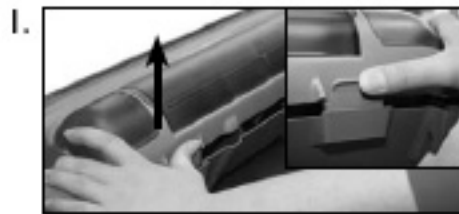

## 1. Opening Safety Wrap® Station:

- Apply inward pressure to latches and lift upward to release.

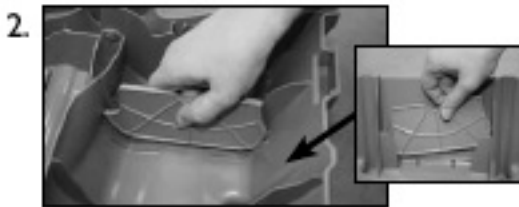

## 2. Adjusting roll adaptors for size of roll

- Insert adaptors in appropriate slot in base to center roll.  
(Note: Adaptors can only be installed into slots in one direction allowing the adaptor to fully insert into the slot, otherwise the roll extends too high. Make sure ends of tubes are seated in the cradle.)
- **Note:** if 18" roll is used, no adaptors are necessary – store adaptors in rear center pocket when not being used.

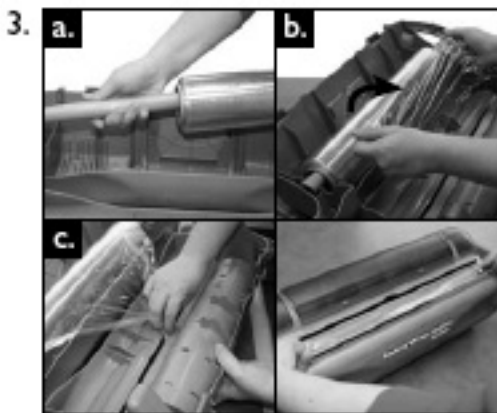

## 3. Loading and Dispensing film or foil

- Insert tube through foil or film, seat roll and tube into unit allowing the film or foil to unroll from the top (as shown) – make sure roll turns freely.
- Unroll approx 12" of film/foil for easiest feeding through dispensing slot, gather ends together in center to feed through center "Easy Feed" slot.
- Close and latch unit. Pull out a few inches of film/foil to stage on blade for first use.

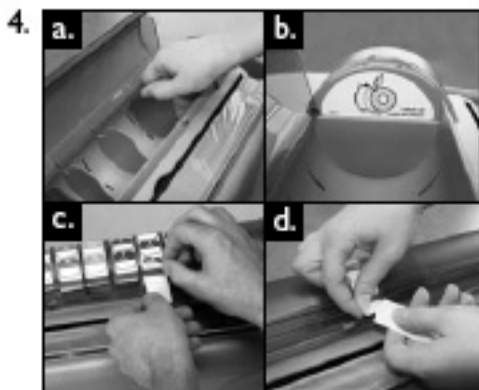

## 4. Loading and Dispensing dating rotation labels

- Open Dating rotation cover.
- Determine size and number of rolls to load (Note: dividers allow range of widths from 3/4" up to 2 1/4" and capacity up to (11) 1" rolls.)
  - Position dividers to hold preferred roll configuration securely in place
  - Referring to the diagram on ends of interior of dating label area, position rolls to dispense as shown – feed strips of labels through slotted cover as shown in diagram.
- Close and snap cover shut
  - To dispense: pull end of strip to self peel labels as shown
  - Manually tear remaining strip backing as needed to not impede foil/film dispensing.



## 5. Loading and Using Tool Storage:

- Push side tabs to open cover; press down securely to latch.



## Replacing Blades

Over time, the Cutting Blade on your SafetyWrap® Station will become dull or soiled and need replacing. Carefully lift the blade off of the SafetyWrap® Station and discard. To install a new blade, line up the underside of the blade with the blade rail and push securely into place.



## Replacement Parts and Accessories

Item Number	Product	Description
SW1218-SC	SafetyWrap® Station Suction Cup Kit	(4) suction cups and (4) screws/washers
SW1218-RC	SafetyWrap® Station Rotation Label Cover	Cover for label compartment
SW1218-CS	SafetyWrap® Station Canopy Set	LH and RH canopies
SW1218-SR	SafetyWrap® Station Support Rod	Support rod assembled with (2) end plugs
SW1218-RD	SafetyWrap® Station Rotation Label Dividers Kit	(4) dividers
SW1218-RA	SafetyWrap® Station Roll Width Adaptors Kit	(2) roll width adapters
SW1218-RB	SafetyWrap® Station Replacement Cutting Blades	(2) replacement blades
SW1218-HB	SafetyWrap® Station Wall Mounting Bracket Kit	(2) wall hanging brackets (fasteners not included)



### Cautions for Safety and Best Results



- Do not load film or foil while hanging on shelf or on wall – always load on secure flat surface with suction cups engaged. Ensure that shelving units are secure before placing the weight of the SafetyWrap® Station in place or using.
- When using on wire shelving, ensure full engagement of hooks to prevent injury and keep an unabated path to prevent accidentally being knocked off of shelf.
- To prevent tipping – ensure suction cups are engaged.
- Use Safety Blade only on film or foil with SafetyWrap® Station. Although blade avoids cuts, parts of surfaces are sharp and should be used with caution.
- Do not place dispenser under heat lamp or next to stove or on hot surface.
- When transporting, ensure all latches and covers are fully latched in the closed position before carrying, especially in a vertical orientation.
- When loading film or foil, use caution when opening – the unit cover with dating label storage may be heavy – use caution and set cover down gently on table when replacing film or foil rolls.
- In the event of film, foil or dating label jamming, ensure unit is on flat, secure surface and open unit to adjust; don't force it to prevent injury.

555 Koopman Lane  
Elkhorn, Wisconsin 53121 USA  
T: 262.723.6133 F: 262.723.4204  
Customer Care: 800.248.9826  
E-mail: [sanjamar@sanjamar.com](mailto:sanjamar@sanjamar.com)  
[www.sanjamar.com](http://www.sanjamar.com)

San Jamar Europe, Inc.  
Schoorstraat 26a, Bus-1  
B-2220 Heist op-den Berg BELGIUM  
T: +32 15 228140 F: +32 15 228148  
E-mail: [sjeurope@sanjamar.com](mailto:sjeurope@sanjamar.com)

San Jamar Mexico, S de RL de CV  
Av Prolongación San Antonio #135  
Col San Pedro de los Pinos  
Alvaro Obregón 01180 México, DF  
P: +52 (55) 3626.0772  
F: +52 (55) 5273.4495  
E-Mail: [sjmexico@sanjamar.com](mailto:sjmexico@sanjamar.com)

**SAN JAMAR**  
Smart ♦ Safe ♦ Sanitary

Part# I00892 071025