

- When the bottle is empty turn the pusher rod 180 degrees (teeth up) and pull rod all the way back. Lift out the empty bottle and replace it with a full one. See Figure 8.

Figure 8

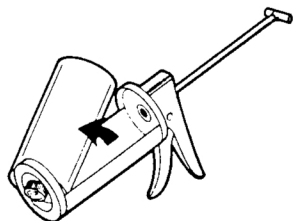

EXPLODED VIEW

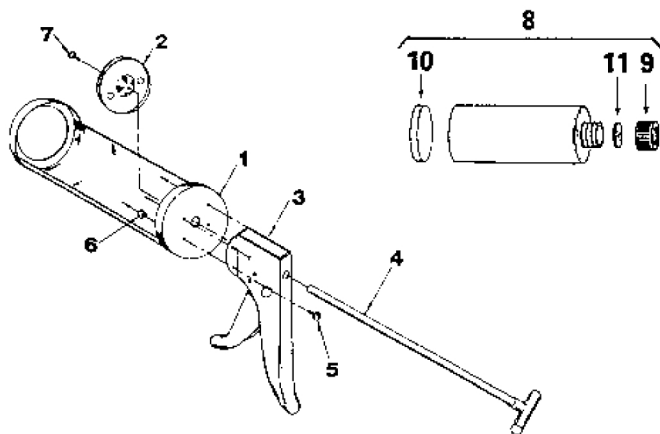

MAINTENANCE

- If for any reason the pusher rod needs to be reinserted into the handle and trigger assembly, **MAKE SURE "PAWLS" ARE BOTH FACING FORWARD** OR DISPENSER WILL FAIL TO OPERATE. See Figure 9.

Figure 9

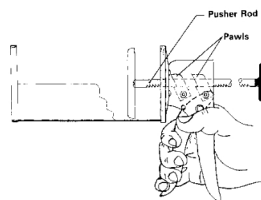

- Be sure to lubricate pusher rod once a day with vegetable oil or shortening to reduce wear of moving parts.

CLEANING

- Spray dispenser with warm water removing excess food particles. Wipe with a dry cloth.
- Remove all parts from bottle, wash and sanitize. See Figure 10.

Figure 10

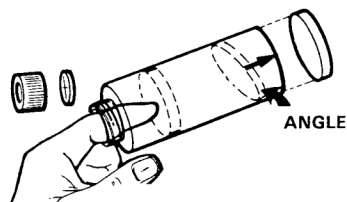

PARTS LIST

ITEM	PART NO.	DESCRIPTION
1	580-4	Cartridge Holder
2	136-21	Piston pusher w / screw
3	580-2	Handle & Trigger Assy, 1/3OZ.
	581-2	Handle & Trigger Assy, 1/2OZ.
	582-2	Handle & Trigger Assy, 2/3OZ.
	583-2	Handle & Trigger Assy, 1OZ.
4	580-3	Pusher Rod, 1/3OZ. RED
	581-3	Pusher Rod, 1/2OZ. WHITE
	582-3	Pusher Rod, 2/3OZ. BLACK
	583-3	Pusher Rod, 1OZ. GREEN
5	76-255	8-32 x 5/16 S.S. Pan Head Screw
6	73-021	8-32 Hex Nut S.S.
7	136-6	Nylok Screw
8	136-1	Bottles (Case of 9) Includes 9, 10, 11
9	136-35	Retainer (Pkg of 10)
10	136-38s	Polypiston (Pkg of 20)
11	136-41	Diffuser (Pkg of 10)
NOT SHOWN	136-36	Spout Cap (Pkg of 10)